

VEHICLE INCURSION

(AREAS WITH THE HIGHEST RESULTS)

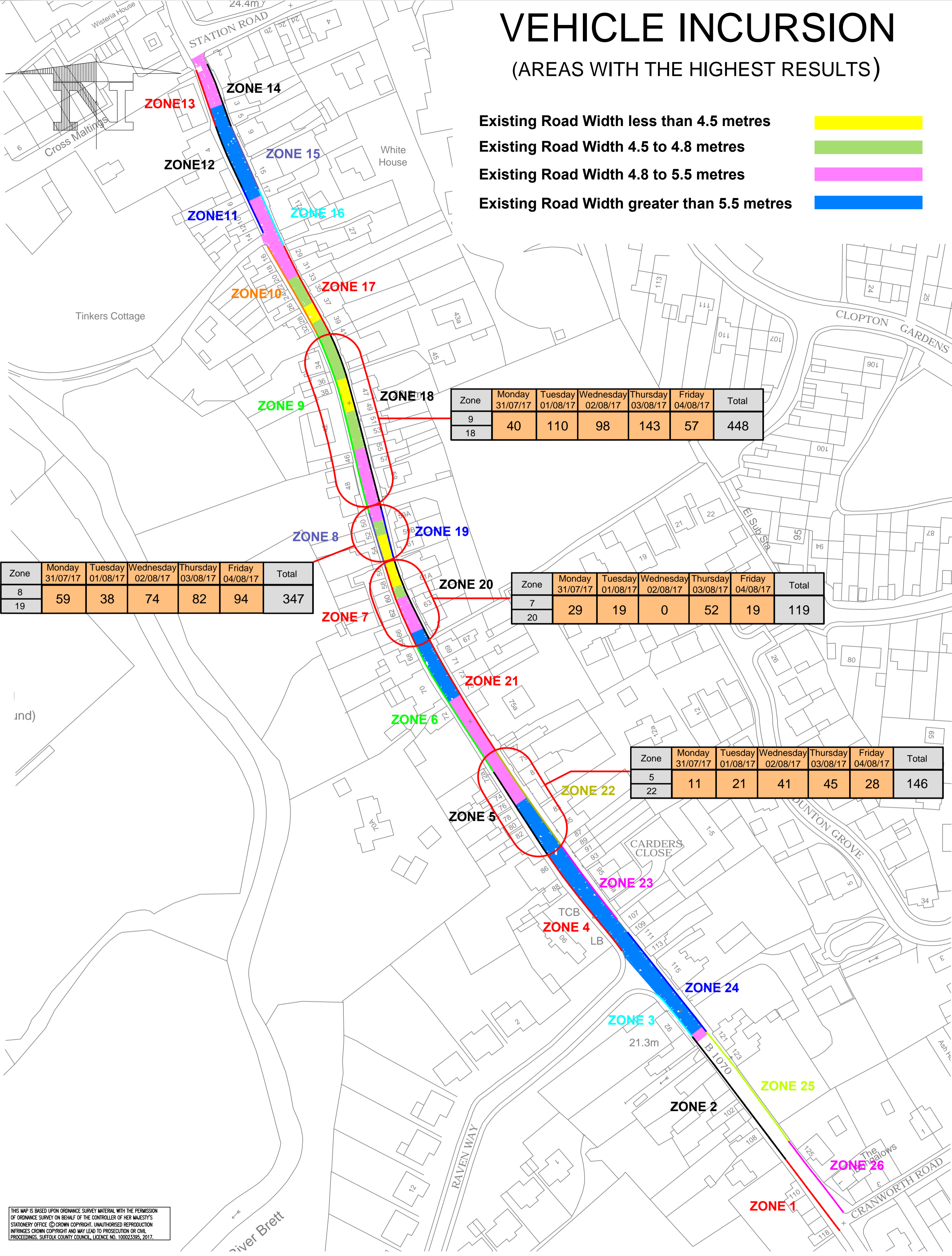

THIS MAP IS BASED UPON ORDNANCE SURVEY MATERIAL WITH THE PERMISSION OF ORDNANCE SURVEY ON BEHALF OF THE CONTROLLER OF HER MAJESTY'S STATIONERY OFFICE. © CROWN COPYRIGHT. UNAUTHORISED REPRODUCTION INFRINGES CROWN COPYRIGHT AND MAY LEAD TO PROSECUTION OR CIVIL PROCEEDINGS. SUFFOLK COUNTY COUNCIL, LICENCE NO. 100023395, 2017.

<p>Suffolk Highways your roads, our business</p> <p>Phoenix House, 3 Goddard Road, Ipswich, Suffolk, IP1 5NP Highways enquiries: 0345 606 6171 www.suffolk.gov.uk/highways</p>	CLIENT	REVISION(S)	PROJECT TITLE	ORIGINATOR	CHECKER	DESIGNER	REVIEWER
			BENTON STREET, HADLEIGH PROPOSED TRAFFIC AMMENDMENTS	Cllr MF	JS	JCCr	JS
				SCALE(S) ORIGINAL SIZE A2 N.T.S.	DATE DEC 17		
	DESCRIPTION	REV.	DATE	INTL.	DRAWING TITLE	DRAWING NUMBER	REVISION
					C.C.T.V RESULTS PLAN	149379 / CRP / 008	